



6 Eastnor House Bretton Green

Bretton PE3 8EA

£745 Per month



6 Eastnor House Bretton Green Bretton PE3 8EA

Located in a central position in Peterborough, this one bedroom apartment is perfect for those who need to be close to the city hospital or the Bretton Centre. The property is well presented and comprises an open plan kitchen/lounge/diner, one double bedroom, a shower room, and allocated parking.

As you enter the property, you are greeted by the spacious open plan kitchen/lounge/diner. The kitchen area features modern eye level and base units, with an integrated oven, hob, extractor, and fridge/freezer. There is also space for a washing machine. The laminate flooring and neutral decor make this space feel bright and modern.

The double bedroom is situated off the main living area and features a neutral decor and carpeted flooring. The shower room is also accessed from the main living area and has a three-piece suite with a shower cubicle, neutral decor, and tiled flooring.

Outside, there is allocated parking available in the private residents car park, providing secure off-street parking for the tenant.





Floor Plan

Hallway:

Kitchen/Lounge/Dining:

11'8 x 10'5

Bedroom:

13'4" x 9'

Shower Room:

Floor Plan

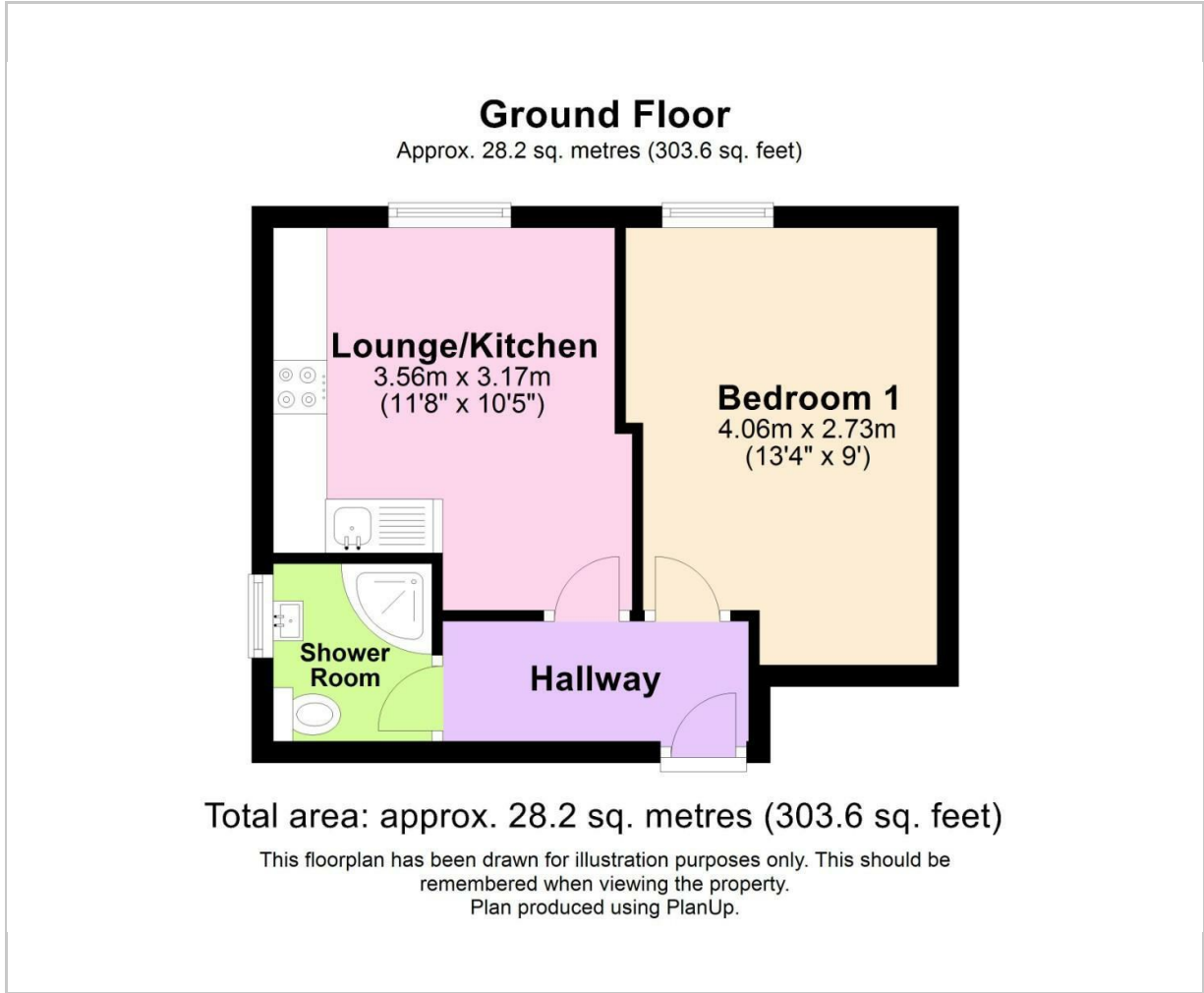

Viewing

Please contact our Lettings Office on 01733 973673 if you wish to arrange a viewing appointment for this property or require further information.

These particulars, whilst believed to be accurate are set out as a general outline only for guidance and do not constitute any part of an offer or contract. Intending purchasers should not rely on them as statements of representation of fact, but must satisfy themselves by inspection or otherwise as to their accuracy. No person in this firms employment has the authority to make or give any representation or warranty in respect of the property.



381 Eastfield Road,
Peterborough, PE1 4RA
T: 01733 973673
E: lettings@firminandco.co.uk

Area Map

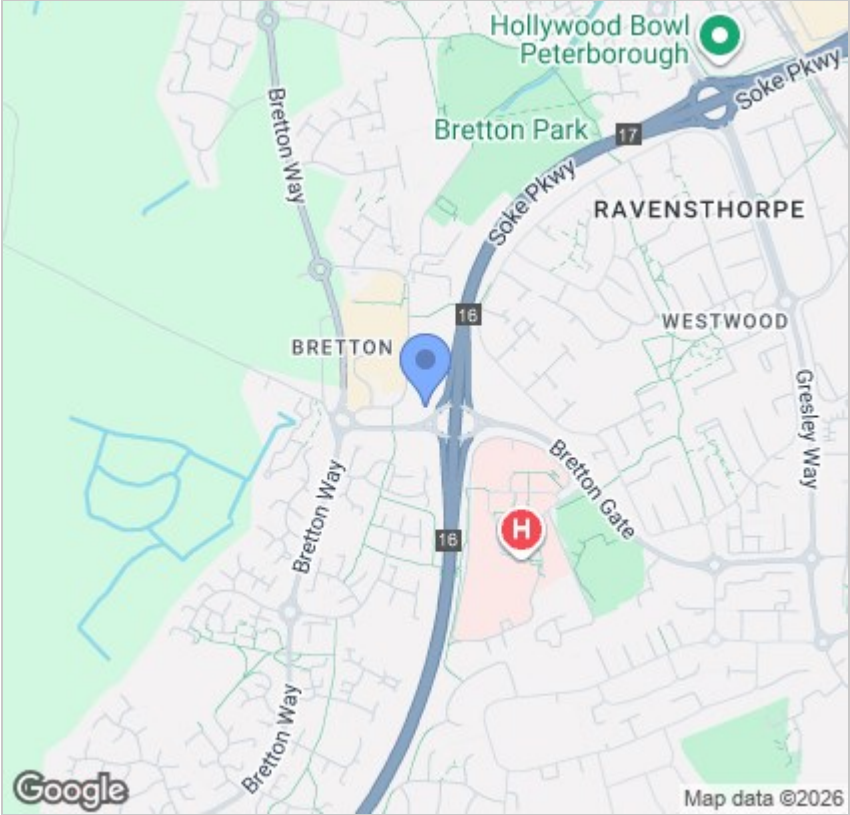

Energy Efficiency Graph

